

COFFEE TABLES

STANDARD FEATURES

- Hard wood frame covered leather.
- Glass top available in all customizing finishes.
- Ceramic top available in all customizing finishes.
- Marble top available in all customizing finishes.

CARATTERISTICHE STANDARD

- *Struttura in legno rivestita in pelle.*
- *Ripiano in vetro disponibile in tutte le finiture presenti in collezione.*
- *Ripiano in ceramica disponibile in tutte le finiture presenti in collezione.*
- *Ripiano in marmo disponibile in tutte le finiture presenti in collezione.*

NOTES

- Dimensions: the first figure shows sizes in centimeters, the second in inches.
- Fabric covering not possible.
- Marble tops slightly juts from the structure's upper level, due to the material's natural thickness.
- Standard stitching customizable with the following stitchings : CUC 501B, CUC 509C, CUC 510, CUC 517 Special.

NOTE

- *Dimensioni: la prima cifra indica i centimetri, la seconda cifra indica i pollici.*
- *Rivestimento in tessuto non possibile.*
- *I ripiani in marmo presentano una leggera sporgenza rispetto alla superficie superiore della struttura, a causa dello spessore naturale del materiale .*
- *Cucitura standard sostituibile con le seguenti cuciture: CUC 501B, CUC 509C, CUC 510, CUC 517 Special.*

ZEN

T275A
73X50XH.38 / 29X20XH.15"

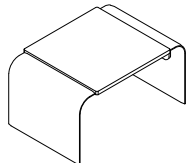

T276A
103X80XH.30 / 41X31XH.12"

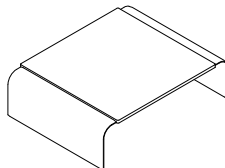

GAMMA
— MADE IN ITALY —